



C18040 & C18041 Installation Procedure

- 1) Remove the center capscrew using a 3/16" Allen key.
- 2) Place one half of the switch bracket on each side of the transmission shifter.
- 3) Loosely install the center capscrew.
- 4) Orientate the switch in the bracket for desired position (on/off) and adjust the height of the bracket for the drivers convenience.
- 5) Torque the capscrew to 50 in-lbs.

Consult the diagrams below for the correct wiring connections:

MANUAL TRANSMISSION ONLY

C18040
C18041

EXHAUST BRAKE CONNECTIONS WITH STANDARD SWITCH

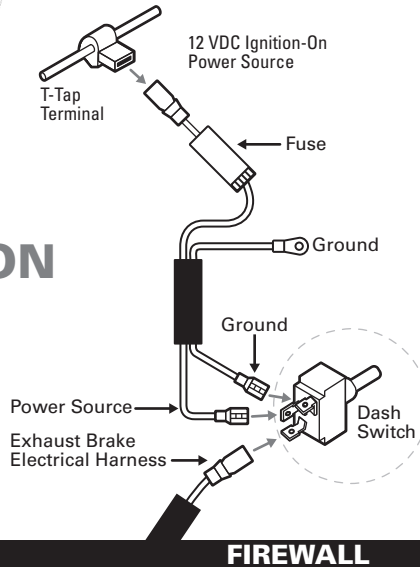

EXHAUST BRAKE CONNECTIONS WITH OPTIONAL SWITCH-PAC

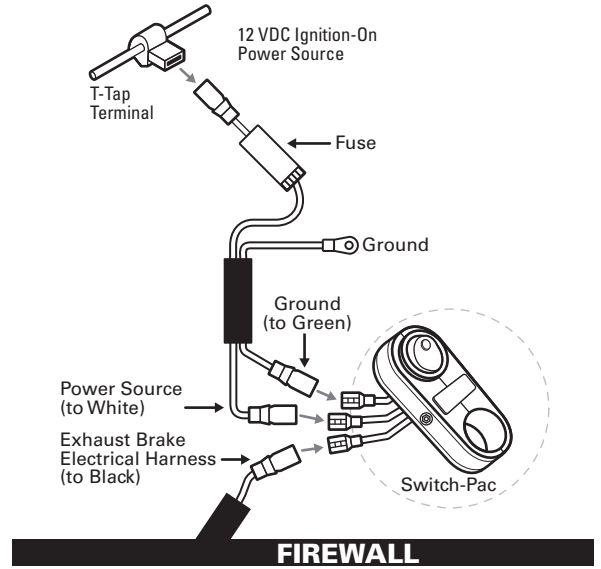

MANUAL TRANSMISSION ONLY

C18042

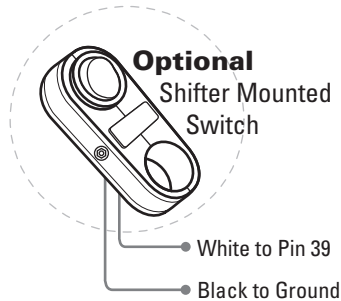

UNIVERSAL ACCESSORY

