

INSTALL INSTRUCTIONS FOR 75-5021

BEFORE YOU START

- Please read the entire product guide before proceeding.
- Ensure all parts are present.
- If you are missing any of the components, call our customer support at (909) 947-0015.
- Do not work on your vehicle while the engine is hot.
- Make sure the engine is turned off and the vehicle is in Park or the Parking Brake is set
- Note: This intake kit may not fit with the following Aftermarket Parts installed: Body Lift or Lowering Kit, Custom Hood, Throttle Body Spacer / Upgrade

REQUIRED TOOLS

- 10mm Wrench & Socket
- 5/16" Nut Driver or Flat Blade Screwdriver
- Phillips Screwdriver, Pliers or Channel locks

STEP 1

With the ignition switched off, place the vehicle in Park and or set Parking Brake. Then disconnect both negative battery cable.

IMPORTANT: Failure to disconnect the battery for a minimum of 2 hours may cause the Check Engine Light to illuminate upon completion of the installation or subsequent operation.

DO NOT SKIP THIS STEP!

STEP 2

Pull up and out to remove the engine cover from the vehicle.



STEP 3

Disconnect the electrical connection to the MAF sensor at the OE airbox.



STEP 4

Pull the crankcase breather line from the OE intake tube and from the engine and remove.

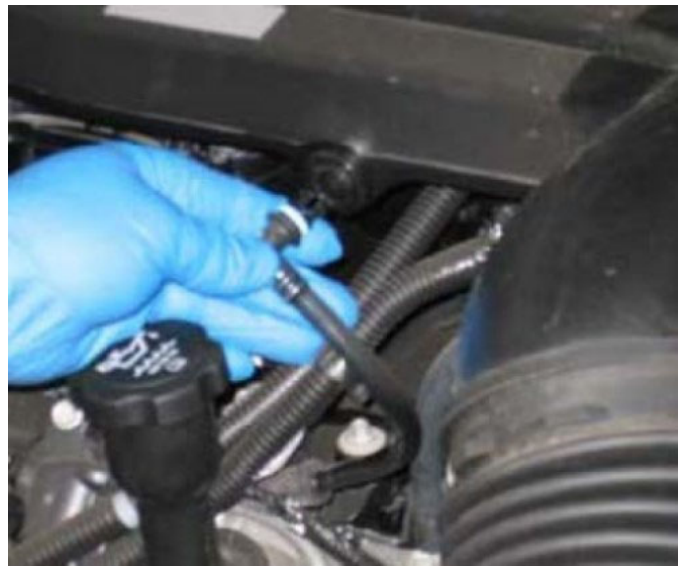

STEP 5

Pry the OE plastic radiator hose binder from the intake tube.



STEP 6

Loosen the hose clamp at the throttle body and at the MAF sensor, remove the OE intake tube from the engine.



STEP 7

Slide the OE airbox towards the engine while pulling up, to remove from the vehicle.



STEP 8

Loosen the hose clamp on the OE airbox and remove the MAF sensor.

Note: Direction of the arrow with regards to flow



STEP 9

Place the S&B filter (D) inside the S&B airbox (H),

then attach the filter adapter (I) to the box using the 5/16 screws (J).



STEP 10

Place the S&B straight adapter (L) over the filter adapter (I) and secure the #60 hose clamp (K) also secure the #80 hose clamp (E) on the filter.



STEP 11

Remove the OE bolt located on top of the core support between the fender and hood bumper, Install the

S&B airbox (H) align prongs to OE grommets and secure the box using the Tapered Allen Head Bolt (F) & Thin SS washer (G) supplied.



STEP 12

Attach the MAF sensor to the S&B filter adapter (I), secure with #60 hose clamp (K).

Note: Direction of the airflow.



STEP 13

Place the S&B hump adapter (M) over the S&B tube (O), slide on until rib on the tube is captured by the groove in the adapter. Then secure with #60 hose clamp (K).

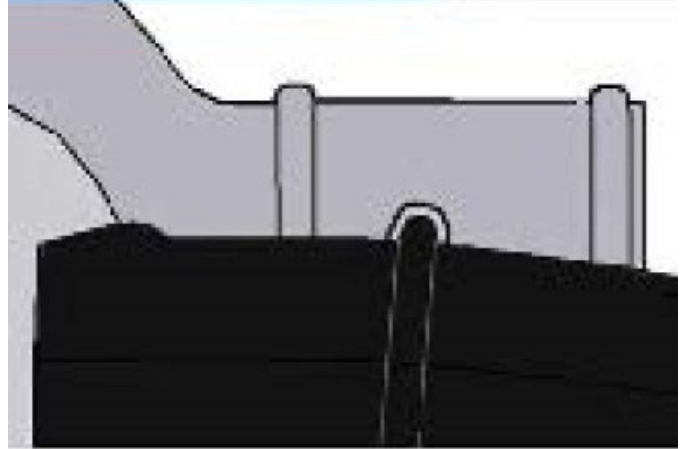

STEP 14

Install the S&B step adapter (P) to S&B tube (O) as shown, secure the #72 hose clamp (R).



STEP 15

Install the S&B tube (O). Place the hump adapter end over the MAF and secure the #60 hose clamp. Then place the other end with the step adapter (P) over the throttle body and secure the #64 hose clamp (S).



STEP 16

Reconnect the MAF sensor's electrical connection.



STEP 17

Install the 3/8" crankcase vent hose (Q) from the

engine over the radiator hose to the S&B Intake tube (O), secure both ends with the #4 hose clamps (N).



STEP 17 (IMAGE 2)



STEP 18

Install the S&B clear lid (C),
secure with 10/24 screws
(A) and sealing washers (B).
Do not overtighten.



STEP 19

Reconnect the battery.
Inspect your installation,
make sure kit is properly
positioned and all fasteners
are secure.

Adhere the C.A.R.B.
exemption sticker in plain
sight under the hood.



Cotton (Cleanable) Dry (Disposable)

Cold Air Intake System Part #: 75-5021 75-5021D

CARB EO #: D-590-14

S&B Filters Inc., Fontana, CA. (800) 358-2639