

INSTALL INSTRUCTIONS FOR 75-5188

BEFORE YOU START

VEHICLE FITMENT: 2020-2024 Nissan Frontier
3.8L

DEVICE NAME: COLD AIR INTAKE

Please read the entire product guide before proceeding.

Ensure all parts are present.

If you are missing any of the components, call our customer support at (909) 947-0015.

Do not work on your vehicle while the engine is hot.

Make sure the engine is turned off and the vehicle is in Park and the Parking Brake is set.

S&B FILTERS recommends that you keep your OE intake system in the event it is required in the future.

In order to maintain your warranty, all connections and components must be checked periodically for alignment and for proper tension on all connections. Failure to do so may void your warranty.

Use only S&B FILTERS cleaning and oil products to service your filter. Using any other brand oil and or cleaners on your S&B air filter may void your warranty

REQUIRED TOOLS

10mm, Socket and 1/4" Drive Wrench

3" Socket Extension

5/16" Nut Driver

Panel Popper

Phillips Screwdriver

Snips

Note: Approximate Install Time: 1 Hr

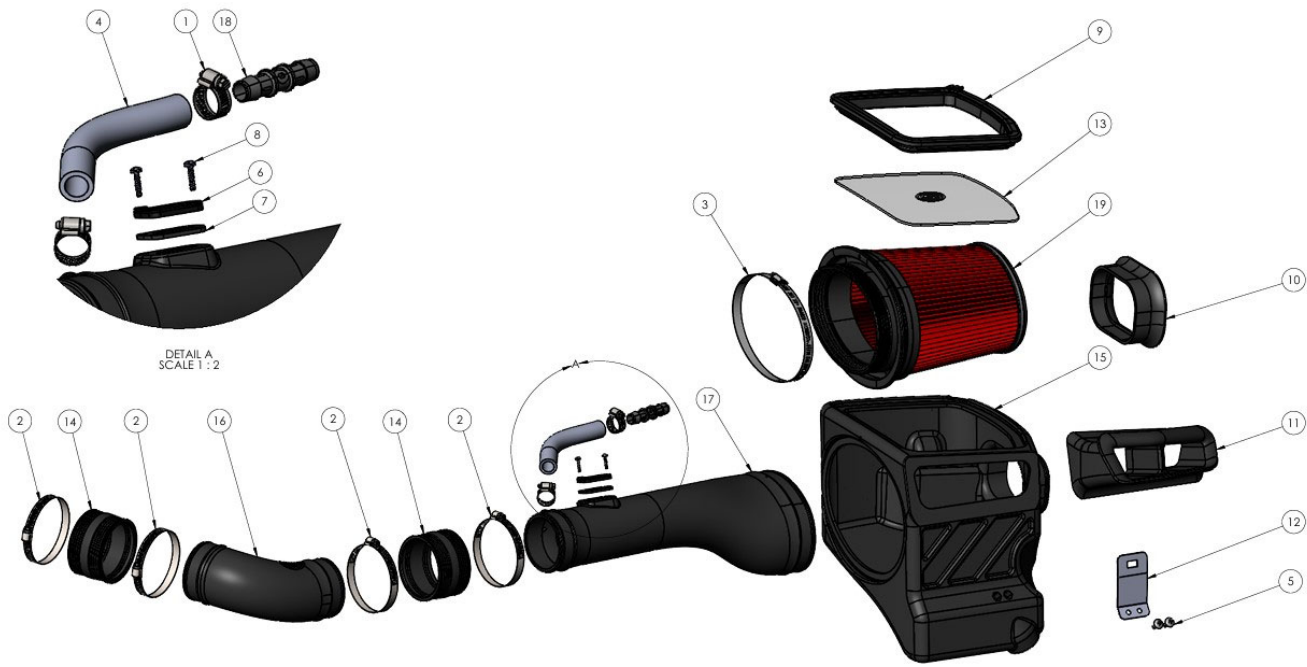

ITEM NO.	PART NUMBER	DESCRIPTION	QTY.
1	AG1000-00	Hose Clamp, #8	2
2	AG1019-00	Hose Clamp, #56	4
3	AG1025-00	Hose Clamp, #128	1
4	AI1039-16	Hose, 5/8" Lock On, 6", BK	1
5	AI1569-00	Truss Head Phillips Screw, 1/4-20 x .50" Long, 18-8 SS	2
6	AI1822-00	MAF Mount, Black	1
7	AI1823-00	Gasket, for MAF mount	1
8	AI1837-00	Screw, SEMS, Pan Head, Phillips, #8-32 X 3/4, SS	2
9	AI3018C-00	Snap in lead	1
10	AI3019C-00	Side scoop	1
11	AI3020C-00	Front scoop	1
12	AI3021-00	Fuse box bracket	1
13	AI3036-00	Polycarbonate lid	1
14	AI3037C-00	Straight Coupler, 3.5" ID x 2.25" Long, Silicone, Comp.	2
15	AL1453B-00	Air box	1
16	AL1454-00	Intake tube	1
17	AL1457-00	Intake Tube, Filter / MAF, 75-5188	1
18	J0099-00	Straight Coupler with 5/8" ID in Black Nylon	1
19	KF-1102A	Replacement Filter	1

STEP 1

Disconnect the negative on the battery. Remove the 2 bolts between the intake tube and engine cover.



STEP 2

Remove the bolt holding the airbox in place.



STEP 3

Loosen the hose clamp on the throttle body.



STEP 4

Squeeze the constant tension clamp and remove the hose from the tube resonator.



STEP 5

Depress button on the MAF sensor and remove.



STEP 6

Remove the clip holding the MAF wire harness

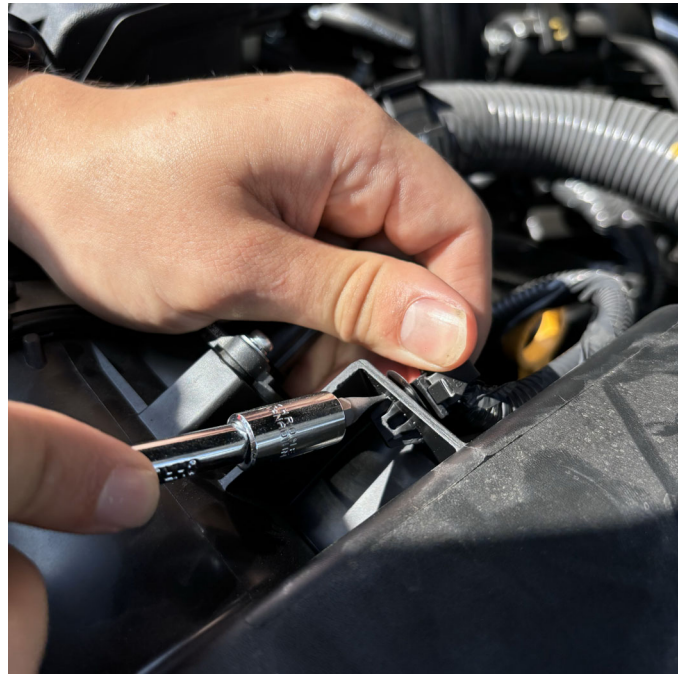

STEP 7

Remove the intake tube/box from the vehicle.



STEP 8

Remove the OEM MAF sensor from the OEM intake tube.

Install the MAF pad (Green arrow) onto the OEM MAF sensor then the MAF gasket (Red arrow) onto the sensor. Install the assembly onto the S&B intake tube.

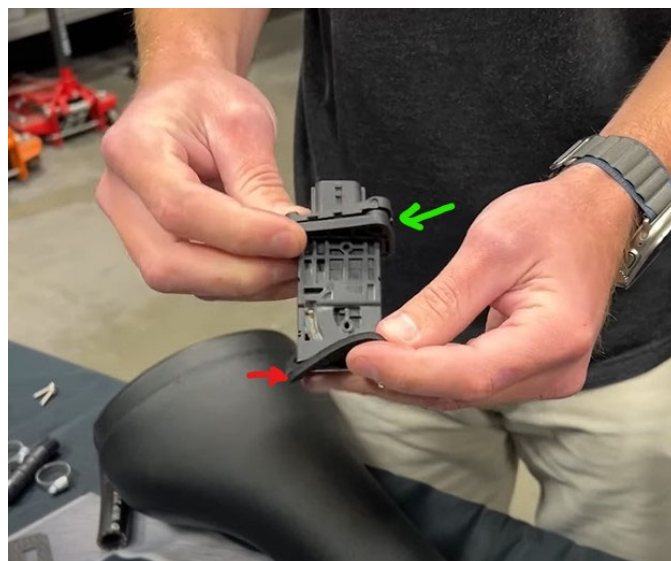

STEP 9

Remove the 2 large grommets from the OEM intake and install onto the S&B airbox.



STEP 10

Remove the grommet and shoulder washer from the OEM intake box and install onto the S&B airbox, the shoulder washer should come into the grommet from the inside



STEP 11

Install the silicone side inlet onto the intake



STEPS FOR AUTO START/STOP TRUCKS (SKIP TO STEP 12 IF YOU DON'T AUTO START/STOP)

If your truck has this fuse box mounted here, please follow the steps below to remount the fuse box.

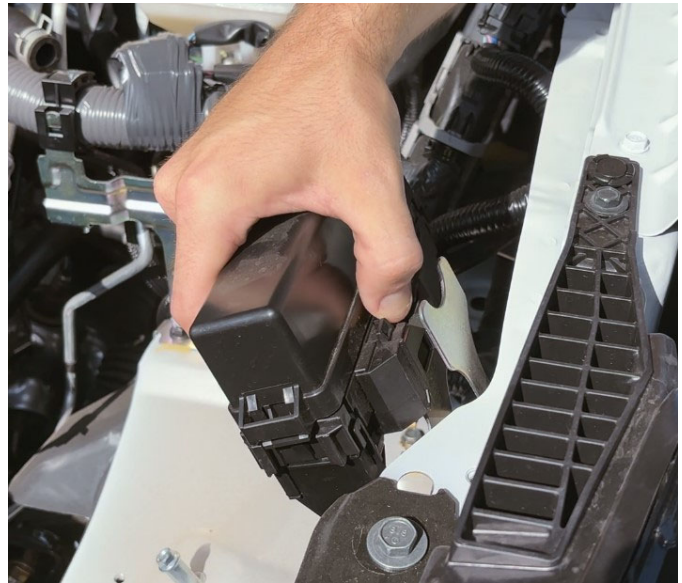

STEPS FOR AUTO START/STOP TRUCKS

Mount the fuse box bracket to the airbox with the

included S&B hardware.

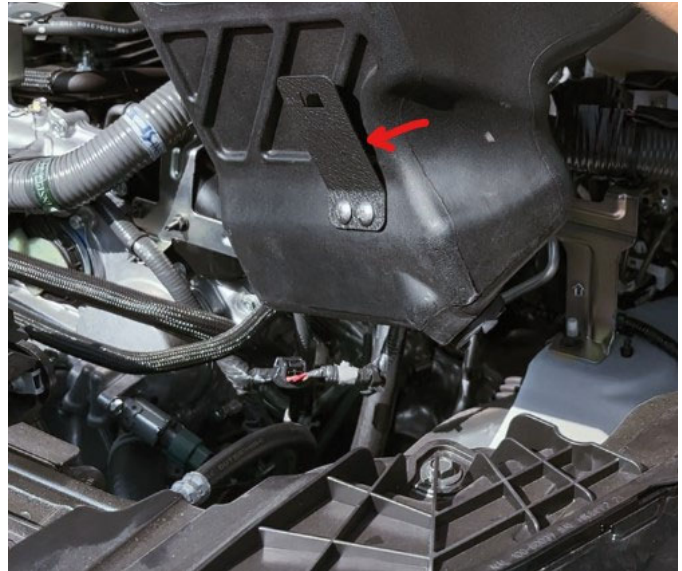

STEPS FOR AUTO START/STOP TRUCKS

Depress the button on the fuse box and set the fuse box aside in the engine bay

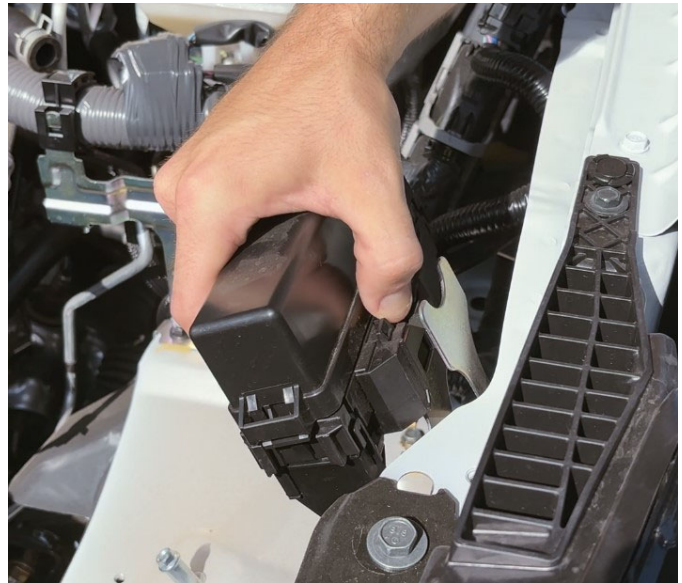

STEPS FOR AUTO START/STOP TRUCKS

Remove the original fuse box bracket, this will not be reused.



STEP 12

Install the airbox into the truck and use the OEM bolt to secure down the box.

If you have the fuse box, make sure its positioned in front of the airbox where it will be held onto the airbox.



STEP 13

Install the fuse box onto the bracket if your truck is equipped with one.



STEP 14

Install the filter into the airbox from the outside. Use the indexing markings on the airbox and filter to help line it up.



STEP 15

Install the front silicone scoop into the S&B airbox with the airbox in the truck



STEP 16

Install the intake tube into the filter then install the coupler and small intake tube onto the throttle body. Join the intake tubes together with all the hose clamps and couplers loose on the tubes. After the tubes are connected, tighten all hose clamps.



STEP 17

Reinstall the MAF sensor.

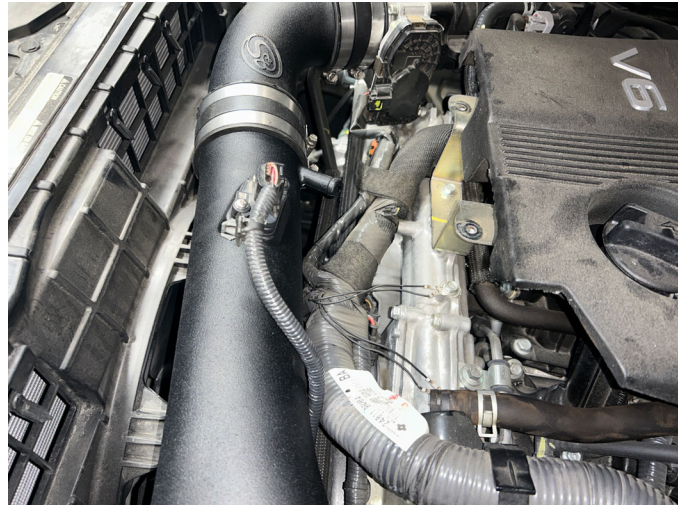

STEP 18

Install the barb to barb adaptor into the included hose. Install the assembly onto the intake tube barb with hose clamps.

Tighten down the hose clamps and secure the constant tension clamp onto the other side of the barb.



STEP 19

Remove the protection layer for the clear lid and install into the lid trim.

Install the lid into the airbox.



STEP 20

Reconnect the negative battery side. Ensure all clamps and bolts are tight and there are clearances with all moving parts.



CARB LABEL

Please affix the included CARB-approved EO label in an area under the hood. We recommend placing it on the radiator shroud, or the underside of the vehicle's

hood near the S&B product.



Vehicle **CARB EO** Label Placement

Sample Label:



S&B FILTERS
PERFORMANCE FILTERS AND INTAKES

Cotton (Cleanable) Dry (Disposable)

Cold Air Intake System Part #: 75-XXXX 75-XXXX

CARB EO #: D-590-28

S&B Filters Inc., Fontana, CA, (800) 358-2639

Locations:

- Under Vehicle Hood**
- Radiator Shroud**
(Preferred location)

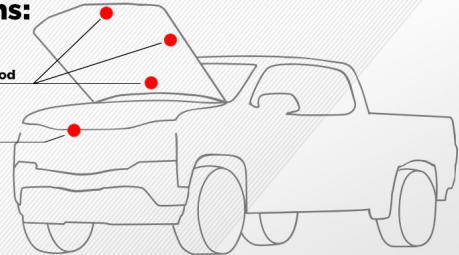

The diagram shows a side profile of a vehicle with its hood open. Red dots indicate the recommended locations for the filter: one on the radiator shroud and three under the hood. Lines connect these dots to their respective labels.