

INSTALL INSTRUCTIONS FOR 75-5191

BEFORE YOU START

VEHICLE FITMENT:

2005-2019 NISSAN FRONTIER

2005-2012 NISSAN PATHFINDER

2005-2015 NISSAN XTERRA 4.0L

DEVICE NAME: COLD AIR INTAKE

Please read the entire product guide before proceeding.

Ensure all parts are present.

If you are missing any of the components, call our customer support at (909) 947-0015.

Do not work on your vehicle while the engine is hot.

Make sure the engine is turned off and the vehicle is in Park and the Parking Brake is set.

S&B FILTERS recommends that you keep your OE intake system in the event it is required in the future.

In order to maintain your warranty, all connections and components must be checked periodically for alignment and for proper tension on all connections. Failure to do so may void your warranty.

Use only S&B FILTERS cleaning and oil products to service your filter. Using any other brand oil and or cleaners on your S&B air filter may void your warranty

REQUIRED TOOLS

10mm, Socket and 1/4" Drive Wrench

3" Socket Extension

5/16" Nut Driver

Panel Popper

Phillips Screwdriver

Snips

Note: Approximate Install Time: 1 Hr

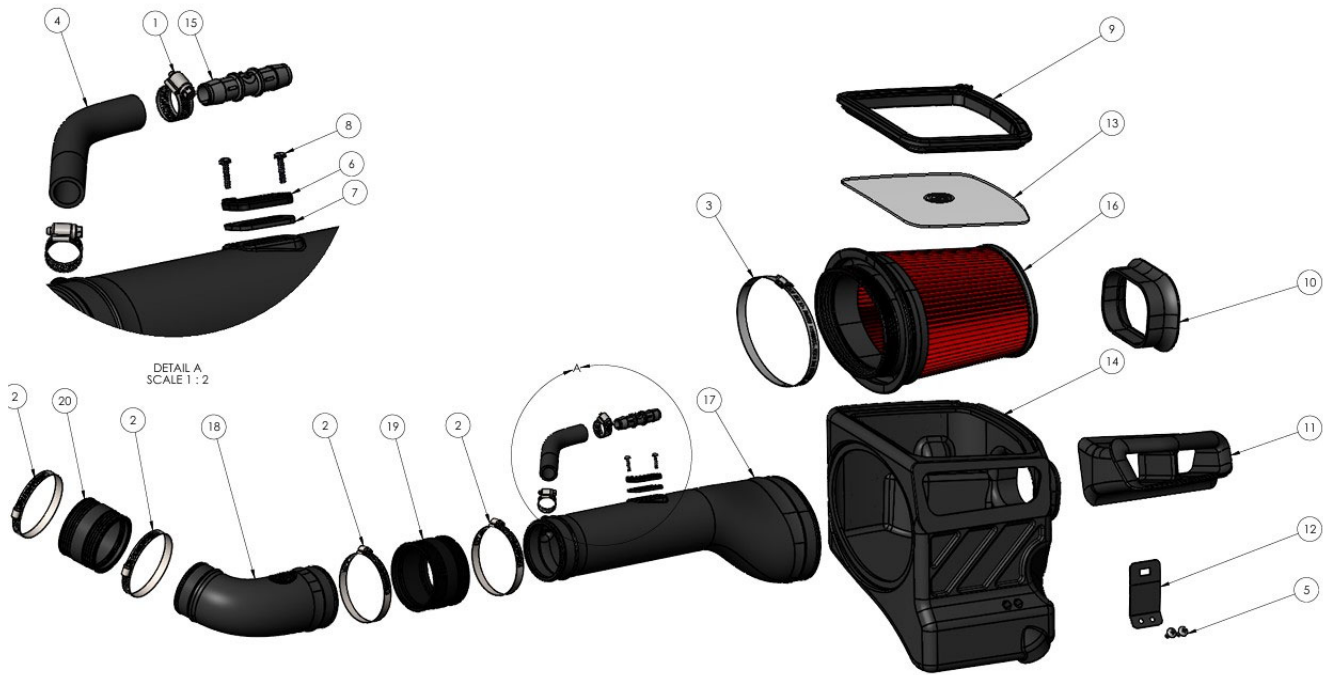

ITEM NO.	PART NUMBER	DESCRIPTION	QTY.
1	AG1000-00	Hose Clamp, #8	2
2	AG1019-00	Hose Clamp, #56	4
3	AG1025-00	Hose Clamp, #128	1
4	AI1039-16	Hose, 5/8" Lock On, 6", BK	1
5	AI1569-00	Screw, 1/4-20 x .50" SS	2
6	AI1822-00	MAF Mount, Black	1
7	AI1823-00	Gasket, for MAF mount	1
8	AI1837-00	Screw, #8-32 X 3/4, SS	2
9	AI3018C-00	Snap In Lid	1
10	AI3019C-00	Side Scoop	1
11	AI3020C-00	Front Scoop	1
12	AI3021-00	Fuse Box Bracket	1
13	AI3036-00	Clear Lid	1
14	AL14538-00	Air Box	1
15	J10099-00	Straight Coupler with 5/8" ID in Black Nylon	1
16	KF-1102A	Replacement Filter	1
17	AL1456-00	Intake Tube, Filter	1
18	AL1455-00	Intake Tube, 75-5191	1
19	AI1678C-00	Straight Coupler, 3.5" ID x 2.25" Long, Silicone	1
20	AI1601C-01	Coupler, Straight	1

STEP 1

Disconnect the negative on the battery. Remove the 2 bolts between the intake tube and engine cover.



STEP 2

Remove the bolt holding the airbox in place.



STEP 3

Loosen the hose clamp on the throttle body.



STEP 4

Squeeze the constant tension clamp and remove the hose from the tube resonator.



STEP 5

Depress button on the MAF sensor and remove.



STEP 6

Remove the clip holding the MAF wire harness

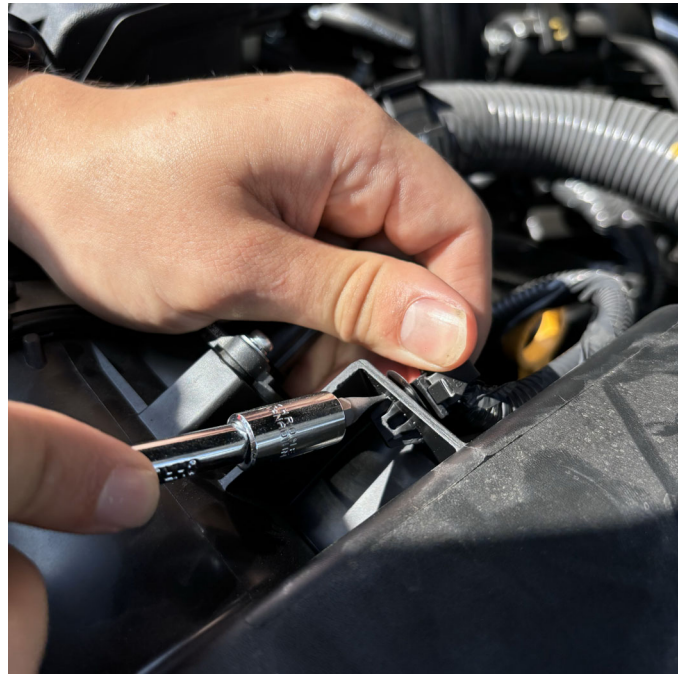

STEP 7

Remove the intake tube/box from the vehicle.



STEP 8

Remove the OEM MAF sensor from the OEM intake tube.

Install the MAF pad (Green arrow) onto the OEM MAF sensor then the MAF gasket (Red arrow) onto the sensor. Install the assembly onto the S&B intake tube.

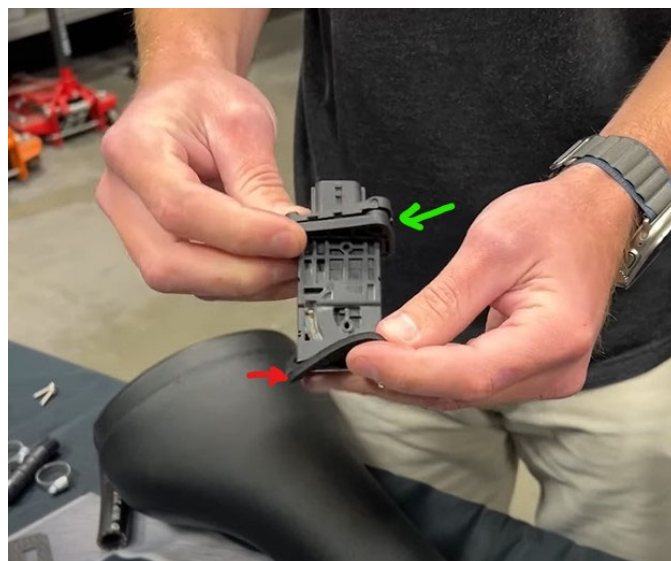

STEP 9

Remove the 2 large grommets from the OEM intake and install onto the S&B airbox.



STEP 10

Remove the grommet and shoulder washer from the OEM intake box and install onto the S&B airbox, the shoulder washer should come into the grommet from the inside



STEP 11

Install the silicone side inlet onto the intake



STEP 12

Install the airbox into the truck and use the OEM bolt to secure down the box.

If you have the fuse box, make sure its positioned in front of the airbox where it will be held onto the airbox.



STEP 13

Install the filter into the airbox from the outside. Use the indexing markings on the airbox and filter to help

line it up.



STEP 14

Install the front silicone scoop into the S&B airbox with the airbox in the truck



STEP 15

Install the intake tube into the filter then install the coupler and small intake tube onto the throttle body. Join the intake tubes together with all the hose clamps and couplers loose on the tubes. After the

tubes are connected,
tighten all hose clamps.



STEP 16

Reinstall the MAF sensor.

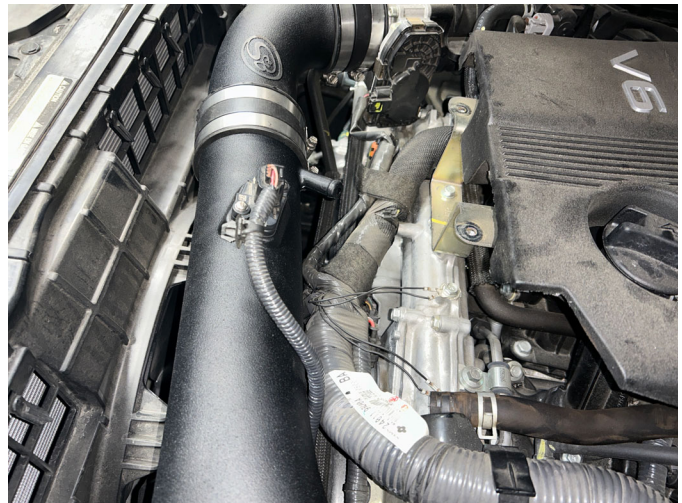

STEP 17

Install the barb to barb
adaptor into the included
hose. Install the assembly
onto the intake tube barb
with hose clamps.

Tighten down the hose
clamps and secure the

constant tension clamp onto the other side of the barb.



STEP 18

Remove the protection layer for the clear lid and install into the lid trim.

Install the lid into the airbox.



STEP 19

Reconnect the negative battery side. Ensure all clamps and bolts and tight

and there are clearances with all moving parts.



CARB LABEL

Please affix the included CARB-approved EO label in an area under the hood, or the radiator shroud, or the underside of the vehicle's hood near the S&B product.



Vehicle CARB EO Label Placement

Sample Label:

	
PERFORMANCE FILTERS AND INTAKES	
Cotton (Cleanable)	Dry (Disposable)
Cold Air Intake System Part #: 75-XXXX	75-XXXX
CARB EO #:	D-590-28
S&B Filters Inc., Fontana, CA, 92530-2639	

Locations:

- Under Vehicle Hood
- Radiator Shroud (Preferred location)

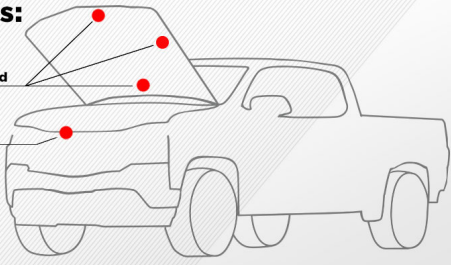
A diagram of a car showing the locations for CARB label placement. Red dots indicate the preferred location on the radiator shroud and other locations under the hood.